

# 1917 68 Smithe Street, Vancouver

\$578,000



Brand new one bedroom + Den + covered balcony with fantastic water and city view on the 19 FL of One Pacific Developed by Concord Pacific. Open floor plan with very functional layout. High end finishing with all meile s/s appliances & hardwood floor. Most desirable Yaletown location, walk distance to costco, T & T, skytrain and water front.

## KEY INFORMATION

MLS® R2129392

Residential Attached

Yaletown

1 Bedroom

1 Bathroom

505 SF

\$211.00 Maintenance Fees

## FEATURES

Year Built: 2016

Listed By: rennie & associates realty ltd.

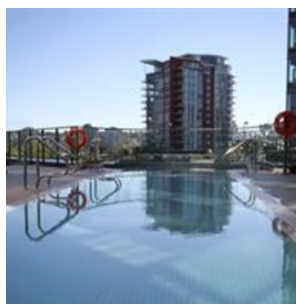
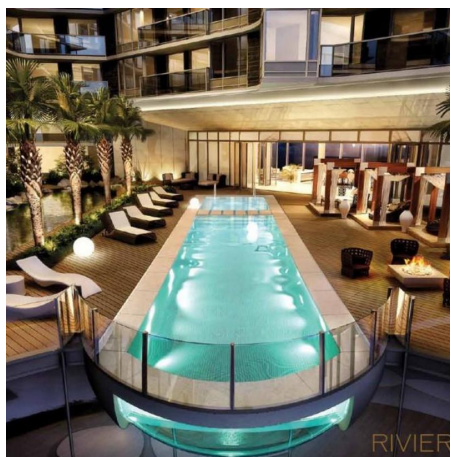

**Art Seroff** PREC\*  
778.223.0033  
aseroff@rennie.com  
rennie.com/artseroff

**rennie**