

# 586 8800 Hazelbridge Way, Richmond

\$935,000



South Estates, the final phase of Concord Gardens, completes this masterpiece in Richmond's Largest World Class Community. Surrounded by beautiful water garden landscaping and meandering pedestrian pathways, come home to a tranquil piece of mind. The amazing 20,000 sq ft Diamond Club, an ultimate playground for entertainment, is an impressive collection of amenities such as a bowling alley, badminton court, indoor swimming pool, private screening, and more. Purposefully designed, with attention to the finest details and accents. You will Appreciate all the little things through timeless design and thoughtfully planned functionality. This 2 bdrm + den, 2 bath is located at the premium North East corner with views of the 70,000 sft community park and water feature. One parking and locker included.

## KEY INFORMATION

MLS®

Residential Attached

West Cambie

2 Bedrooms

2 Bathrooms

882 SF

\$375.00 Maintenance Fees

## FEATURES

Listed By: rennie & associates realty ltd.

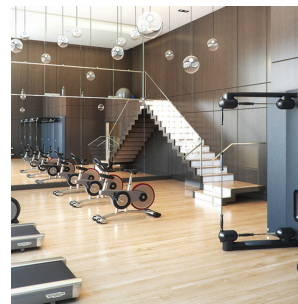
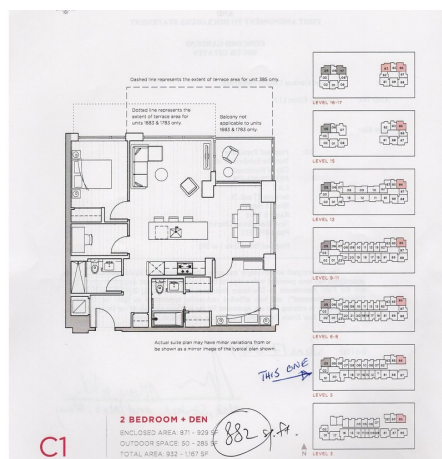

**Hanson Lu** PREC\*  
604.787.2578  
hlu@rennie.com  
rennie.com/hansonlu

**rennie**