

# 301 68 Smithe Street, Vancouver

\$649,000



ONE PACIFIC: Location, amenities, lifestyle highlights this One-Bedroom and Den unit. This efficiently laid-out AIR CONDITIONED home features Miele appliances including a gas cooktop, quartz counters, and a walkout PATIO overlooking the Riviera Deck with the iconic cantilevered GLASS BOTTOM POOL. This complex features top-notch amenities with a large lounge, sauna and steam room, fitness gym, rooftop bbq area and children's playground, 24 hr CONCIERGE, hot tub, pool and cabanas. Located steps from False Creek SEAWALL and Cooper's Park, Yaletown, Urban Fare, Roundhouse Community Centre, Parq Vancouver and it's world class dining and entertainment, Urban Fare, and the Canada Line. Pet and Rental friendly. Call for your private showing.

## KEY INFORMATION

MLS® R2396094

Residential Attached

Downtown

1 Bedroom

1 Bathroom

569 SF

\$298.48 Maintenance Fees

## FEATURES

Year Built: 2016

Listed By: rennie & associates realty ltd.

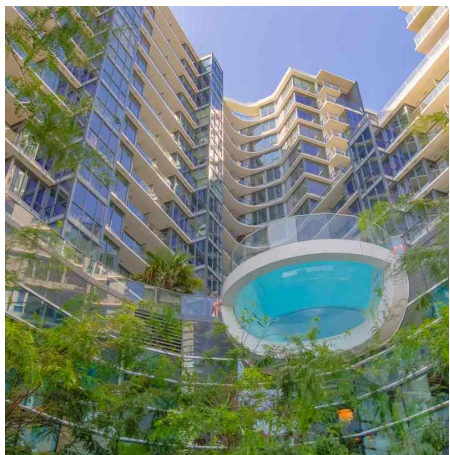

**Shelly Vellani** PREC\*  
604.710.3681  
svellani@rennie.com  
rennie.com/shellyvellani



**Nagib Karim** PREC\*  
604.999.5887  
nkarim@rennie.com  
rennie.com/nagibkarim

**rennie**