

401 2501 Spruce Street, Vancouver

\$1,350,000



Distinctive 10-storey building presides over Broadway and Spruce in Vancouver's Fairview neighborhood. This presale 2 Bedroom unit has contemporary interiors that are elegantly designed with top-of-the-line Miele appliances. Beautiful Design by award winning designer GBL architects with spacious floor plans. Prime location with close proximity to transits, shopping centres & schools. Call now for inquiries!

KEY INFORMATION

MLS® R2577571

Residential Attached

Fairview

2 Bedrooms

2 Bathrooms

883 SF

\$546.00 Maintenance Fees

FEATURES

Year Built: 2024

Listed By: Sutton Group-West Coast Realty



7 Bath + 7 Bath

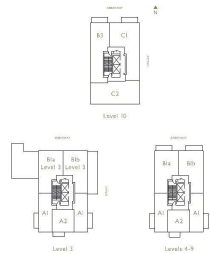

rennie