

# 3603 1188 Pinetree Way, Coquitlam

\$565,000



This is a lovely Northwest corner unit in M3 built by Cressey with amazing panoramic views in the heart of Coquitlam. Very functional floor plan including generous size bedroom, walking closet and kitchen with quartz counter top, Gas cooktop and Bloomberg appliances. Enjoy the Summit Club with gym, yoga, music, game room, party room and also a park with play ground. Steps to skytrain station, shopping, restaurants and more. Truly a pleasure to show.

## KEY INFORMATION

MLS® R2590815

Residential Attached

North Coquitlam

1 Bedroom

1 Bathroom

578 SF

\$207.56 Maintenance Fees

## FEATURES

Year Built: 2016

Views: CITY

Listed By: rennie & associates realty ltd.

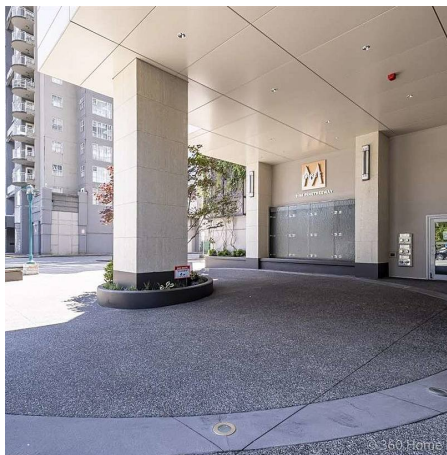

**Candice Ko**  
604.729.7842  
cko@rennie.com  
rennie.com/candiceko

**rennie**