

2266 Pitt River Road Road, Port Coquitlam

\$1,399,999

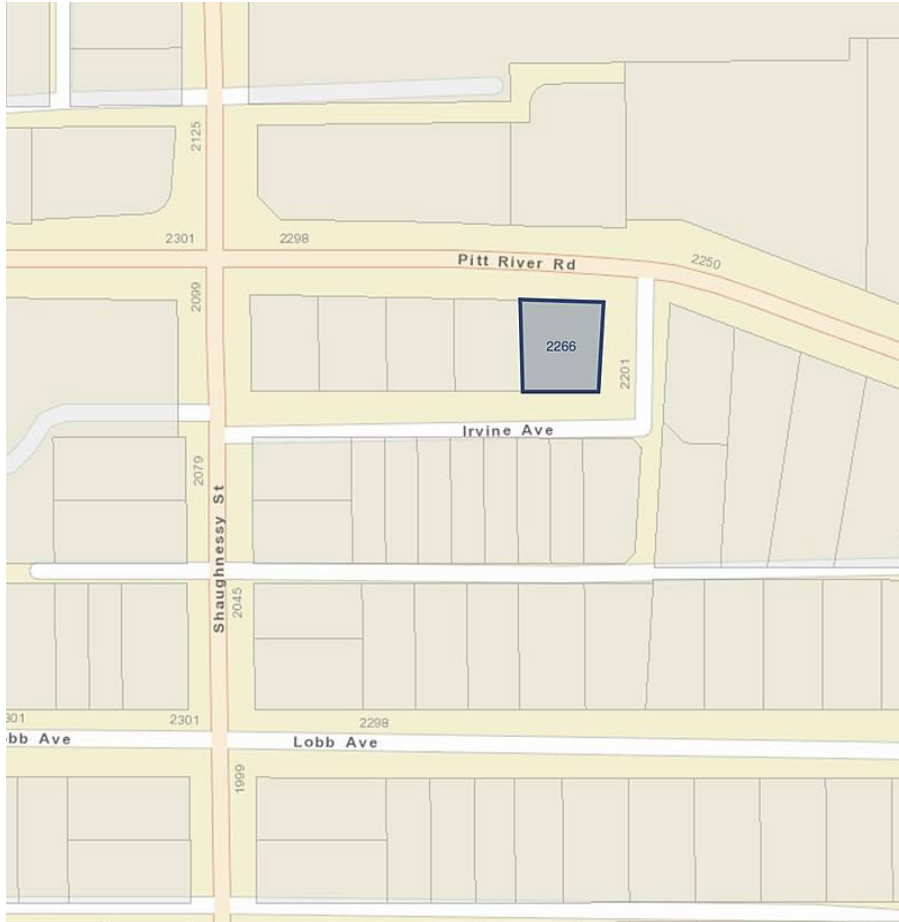

****Investor, Developer & Builder Alert**** This is a sub-dividable property. Option 1: Sud-divide from one RS4 (Residential Single Dwelling 4) to 2 RSL (Small lot Residential) lots. Each RSL lot will be at least 3,229 sqft with at least 31.2 ft(9.5m) frontage and 92ft(28m) depth. Variance permit is required for the depth. Another option is to buy all 5 properties on Pitt River Road: 2272, 2280, 2288 and 2296 Pitt River Rd and potentially build townhouses or condos. Rezoning will be required in order to do this. All 5 properties are up for sale.

KEY INFORMATION

MLS® R2595079

Residential Detached

Mary Hill

5 Bedrooms

2 Bathrooms

2,740 SF

7,040 SF Lot

FEATURES

Year Built: 1945

Listed By: Sutton Group-Alliance R.E.S.

