

2296 Pitt River Road, Port Coquitlam

\$1,399,999

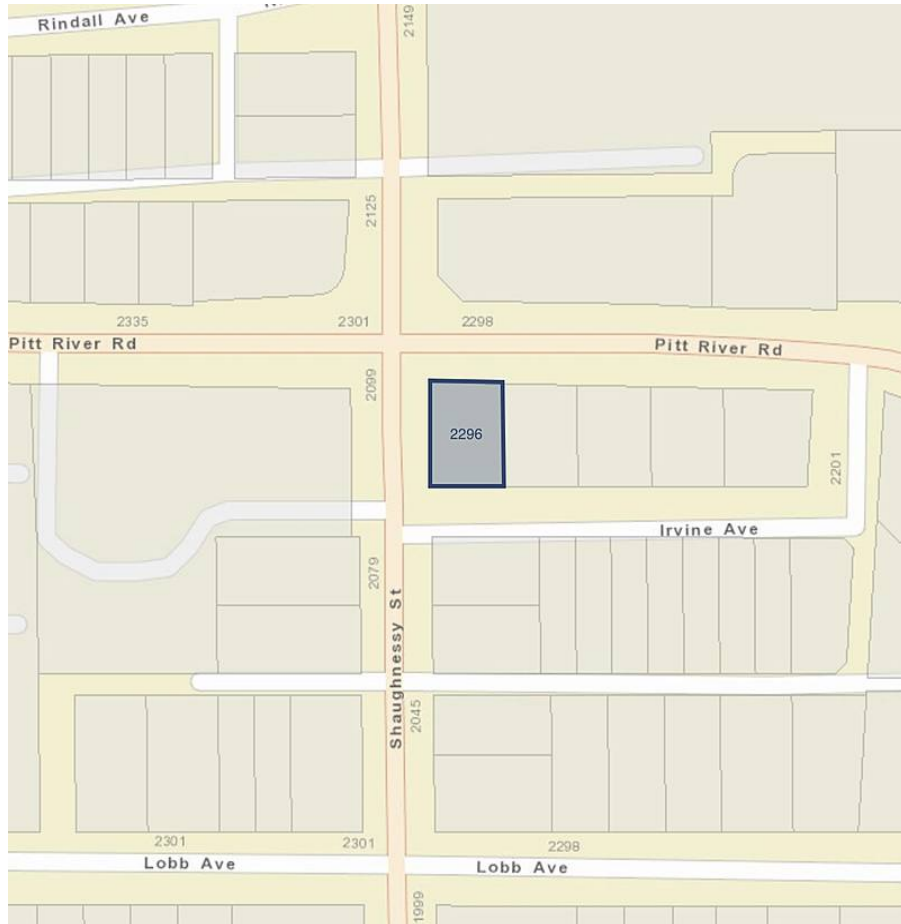

****Investor, Developer & Builder Alert** LAND ASSEMBLY**.** Option 1: Buy 2280, 2288 and 2296 Pitt River and Sud-divide from 3 RS4 (Residential Single Dwelling 4) to 5 RSL (Small lot Residential) lots. Each RSL lot will be at least 3,229 sqft with at least 31.2 ft(9.5m) frontage and 92ft(28m) depth. Variance permit required for depth. Option 2: Buy all 5 properties on Pitt River Road: 2266, 2272, 2280, 2288 and 2296 Pitt River Rd and potentially build townhouses or condos. Rezoning will be required in order to do this. All 5 properties are up for sale.

KEY INFORMATION

MLS® R2595089

Residential Detached

Mary Hill

2 Bedrooms

2 Bathrooms

2,322 SF

6,317 SF Lot

FEATURES

Year Built: 1965

Listed By: Sutton Group-Alliance R.E.S.

