

9671 161a Street, Surrey

\$2,588,000



INVESTOR ALERT! DEVELOPMENT POTENTIAL in the Tynehead area. Comfortable rancher-style family home situated on very large rectangular lot - total 1.48 acres - with 186 foot frontage. Backs onto greenbelt (park). Generous room sizes through-out including three bedrooms plus a family room. Closes to schools, freeway and shopping. Rent out the house while you plan!

KEY INFORMATION

MLS® R2597946

Residential Detached

Fleetwood Tynehead

3 Bedrooms

2 Bathrooms

1,495 SF

FEATURES

Year Built: 1972

Listed By: Royal LePage Brent Roberts Realty

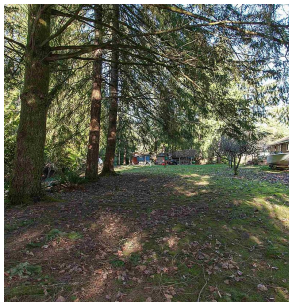
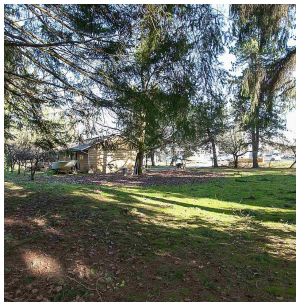
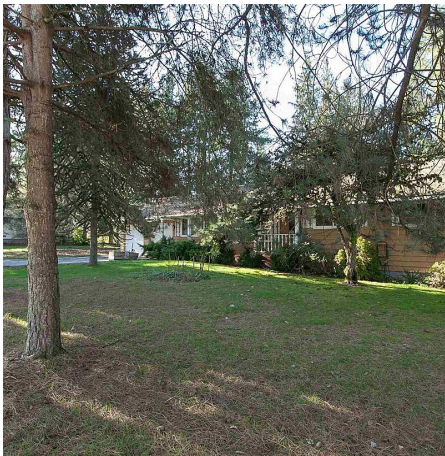

rennie