

42395 Highland Drive, Chilliwack

\$2,959,900



AN ESTATE LIKE NO OTHER! This custom built 7585 sq ft RANCHER w/ WALKOUT BSMT features 7 bdrms & 7 bathrooms & is ready for the most discerning of buyers. Constructed in 2010 w/ no expense spared, the list of features is IMPRESSIVE. Handscrapped teak flooring, ample millwork, barrel & vaulted ceilings w/ white washed pine - stunning! Designed to maximize light & VIEWS. MASSIVE master suite feat. a 6 piece ensuite w/ steam shower & 175 sqft custom closet. Gourmet Kitchen & suspended slab patio w/ outdoor fireplace. 3654 sq ft bsmt w/ 1600 sqft BEAUTIFUL 2 bdrm/2 bath SUITE; finished the same as upper levels. ICF Foundation, 400 amp service, drilled well, multi-function heating systems w/ AC- 4 page feature list available! All this & 2.5 MANICURED ACRES w/ zen gardens & room for a shop/barn.

KEY INFORMATION

MLS® R2609429

Residential Detached

Chilliwack

7 Bedrooms

7 Bathrooms

7,585 SF

FEATURES

Year Built: 2010

Views: Incredible VALLEY Views

Listed By: Century 21 Creekside Realty

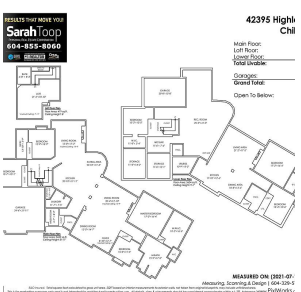

rennie