

1205 9171 Ferndale Road, Richmond

\$658,000



Updated penthouse by Concord Pacific. Unobstructed panoramic view to amazing park and mountain view. Great functional floor plan with 2 bedrooms plus den, granite counter, laminate floor and newer lighting fixture. Easy to access to Vancouver, YVR, Kwantlen College, Lansdowne Mall, Richmond Centre. Steps to Anderson Elementary and McNeil Secondary School. All measurement approx. and buyer must verify if important. Allow time for showing. Open house: Aug 21 and 22, Sat and Sun, 2-4 pm.

KEY INFORMATION

MLS® R2609817

Residential Attached

Mc Lennan North

2 Bedrooms

2 Bathrooms

955 SF

\$521.84 Maintenance Fees

FEATURES

Year Built: 2008

Views: PANORAMIC PARK, MOUNTAIN & CITY

Listed By: Pacific Evergreen Realty Ltd.

Richmond BRITISH COLUMBIA

penthouse 1205
2 bedrooms - 2 bathroom
living area 955 ft²
balcony 67 ft²

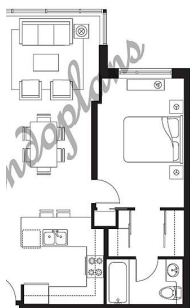

mycondoplans® Any publishing is forbidden. The information is from sources deemed reliable, but is not guaranteed and should be used as a guide only.

rennie