

# 2145 Mckenzie Road, Abbotsford

\$1,550,000

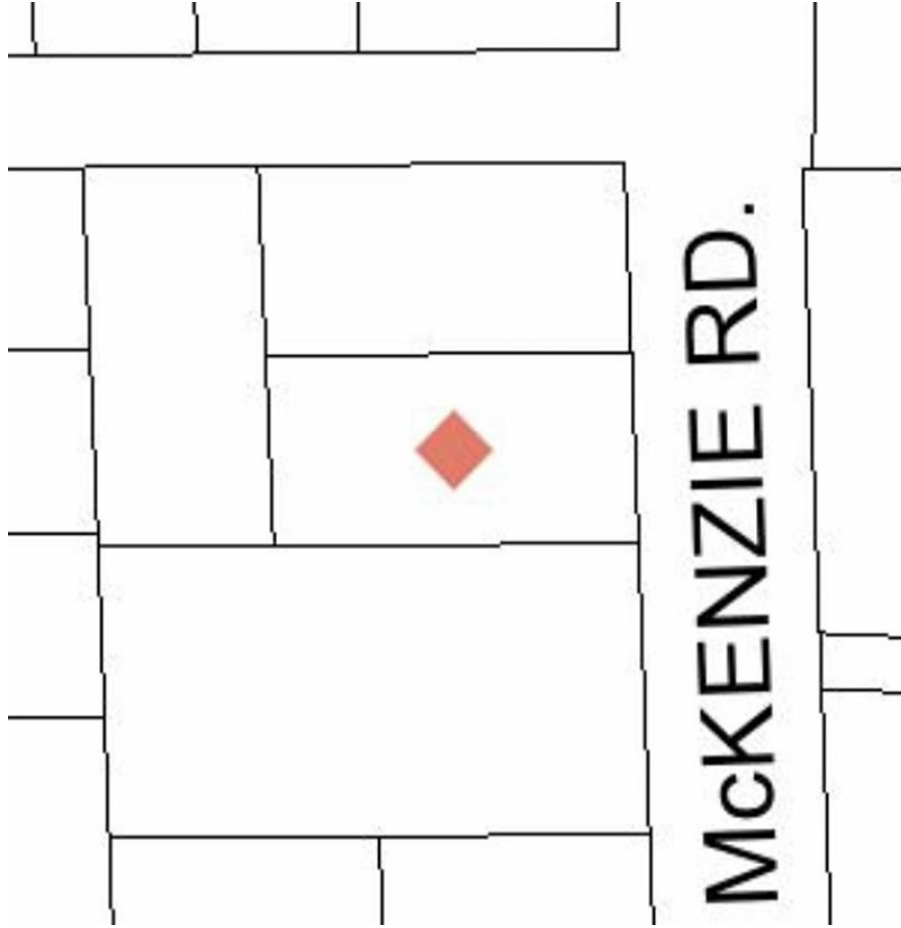

Great Investment property on 9,180 Sq. ft. Lot. OCP shows multifamily zoning and right next commercial zoning.

### KEY INFORMATION

MLS® R2638664  
Residential Detached  
Central Abbotsford  
5 Bedrooms  
0 Bathrooms  
2,155 SF  
9,180 SF Lot

### FEATURES

Year Built: 1954  
Listed By: Sutton Group-Alliance R.E.S.