

313 8725 Elm Drive, Chilliwack

\$339,000



Beautiful mountain and city views from each room in this condo! Spacious, bright, over 1400 sq. ft. in desirable 50 PLUS Elmwood Terrace. Top floor, south east facing 2 bed 2 bath corner condo featuring a fabulous enclosed sun room, walk-in tub, room for your hobbies and family visits. Amenities include a large meeting room, pool table and exercise room, and wood working shop. In addition to a large amount of in-suite storage, this unit also comes with an extra store unit on the same floor. Unit comes with a secure underground parking stall as well as an area to wash your vehicle. C Walk to all amenities! Don't miss out, come view today!

KEY INFORMATION

MLS® R2667582

Residential Attached

Chilliwack

2 Bedrooms

2 Bathrooms

1,437 SF

\$491.00 Maintenance Fees

FEATURES

Year Built: 1987

Views: City and Mountain views

Listed By: rennie & associates realty ltd.

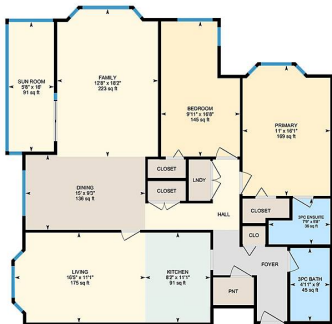

Elm Dr - Chilliwack, BC

TOTAL SQUARE FEET: 1,437



Ryan O'Hearn PREC*
778.384.2667
rohearn@rennie.com
rennie.com/ryanohearn

rennie