

5709 Lindys Drive, Chilliwack

\$1,199,900



Sardis Family DREAM Home! RENOVATED & move-in ready, this pristine 4 bdrm & 4 bathroom home is loaded w/ extras & only BLOCKS from Webster Park, Watson Glen Park, Peach Park, Unsworth Elem., Mt. Slesse Middle, & of course the famous Vedder River Rotary Trail! Main floor w/ open concept kitchen feat SS appliances & oversized island, lrg living room w/ custom fireplace, German laminate flooring, modern fixture, & access to a MASSIVE 12x24 COVERED patio w/ gas line & stairs to the incredible backyard. Manicured, fenced, & complete w/ a custom playhouse! Upper floor is 3 bdrms & flex area w/ b.i. desk. WALKOUT DAYLIGHT BSMT w/ rec room, bathroom, 4th bdrm, & storage (suite-able). HEAT PUMP A/C, Hot Water on Demand, b.i. speakers, b.i. vac, & DBL garage w/ workbenches & TRIPLE wide driveway!

KEY INFORMATION

MLS® R2684614

Residential Detached

Chilliwack

4 Bedrooms

4 Bathrooms

2,689 SF

4,263 SF Lot

FEATURES

Year Built: 2002

Views: Mountains

Listed By: Century 21 Creekside Realty

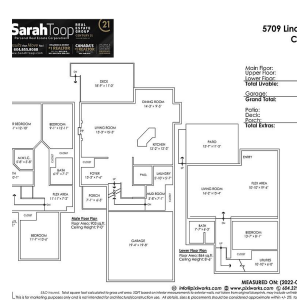

rennie