

10269 132 Street, Surrey

\$1,499,999

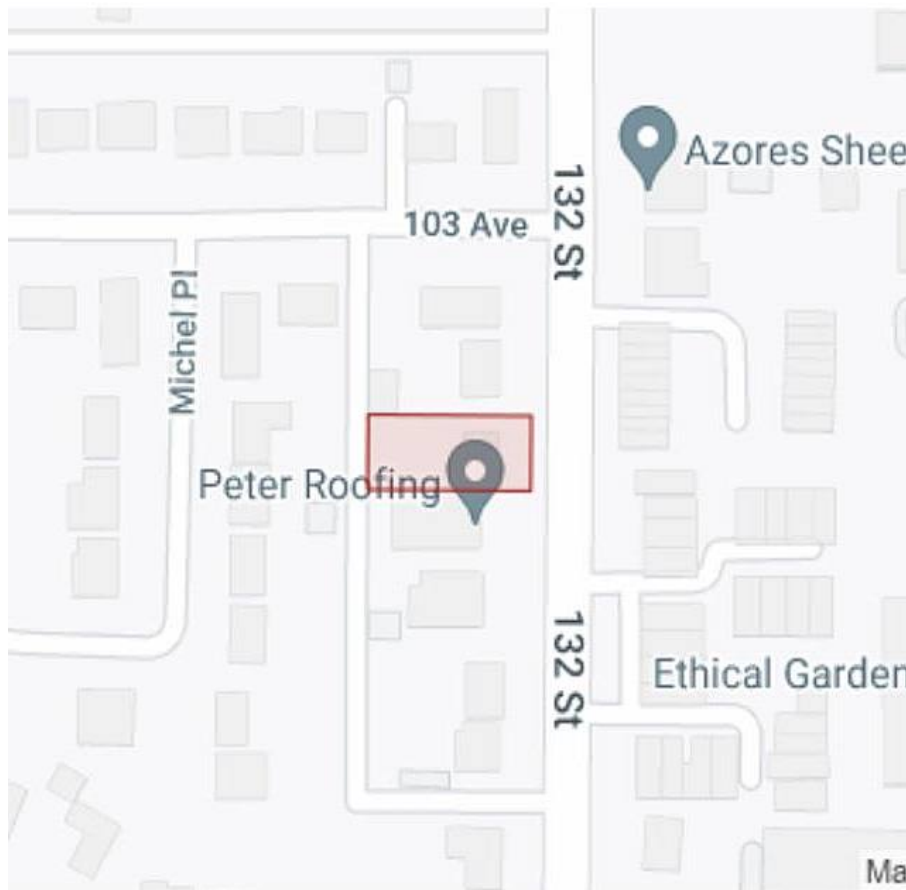

Prime!!! Prime!!! Prime!!! Peace of Land Golden Opportunity to own a Property in the Heart of Surrey Downtown . Builders!!!Investors!!! Developers!!! Alert!!! Huge 65' x 145' (9455 sq ft) lot in Surrey Central City area built a Big Home or Develop multiple homes Duplex(Check and Verify with the City) . Rear lane Access makes it Convenient West facing Back yard. Current home needs Renovations. Property is Sold as where is.

KEY INFORMATION

MLS® R2701284

Residential Detached

Whalley

2 Bedrooms

1 Bathroom

1,080 SF

9,455 SF Lot

FEATURES

Year Built: 9999

Listed By: Century 21 Coastal Realty Ltd.

