

# 711 13615 Fraser Highway, Surrey

\$499,900



Welcome to King George Hub. LIVE, WORK, PLAY & TRANSIT in this new and vibrant master-plan community by Warrington PCI. Offering retail, groceries and dining at your doorstep and FULL-SCALE AMENITIES include rooftop lounge, Podium lounge and playground, gym, social room. This SOUTH facing 1 yr old home boasts laminate flr thru-out, BOSCH kitchen appliances with integrated dishwasher and fridge, in-suite laundry/storage closet, deep soaker tub. Complete with 1 PARKING & 1 LOCKER. COMMON BIKE ROOM available. Move-in or invest in this PERFECT ONE BED FLAT!

## KEY INFORMATION

MLS® R2719498

Residential Attached

Whalley

1 Bedroom

1 Bathroom

506 SF

\$251.75 Maintenance Fees

## FEATURES

Year Built: 2021

Views: Open Southern View

Listed By: rennie & associates realty ltd.

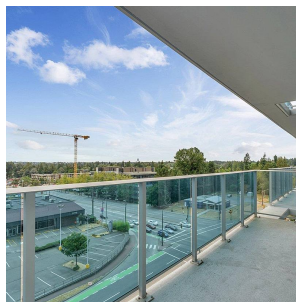
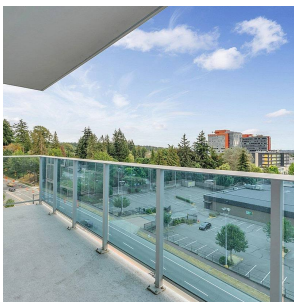
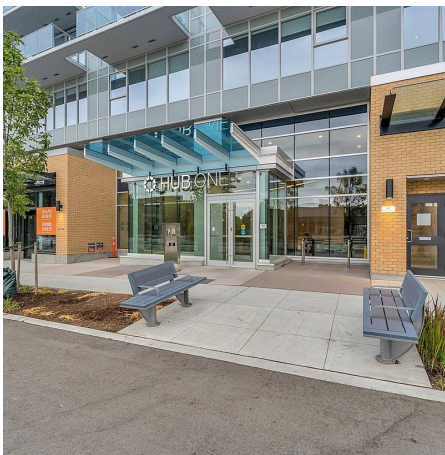

**Linda Kang**  
604.787.5923  
lkang@rennie.com  
rennie.com/lindakang

**rennie**