

702 5766 Gilbert Road, Richmond

\$919,900

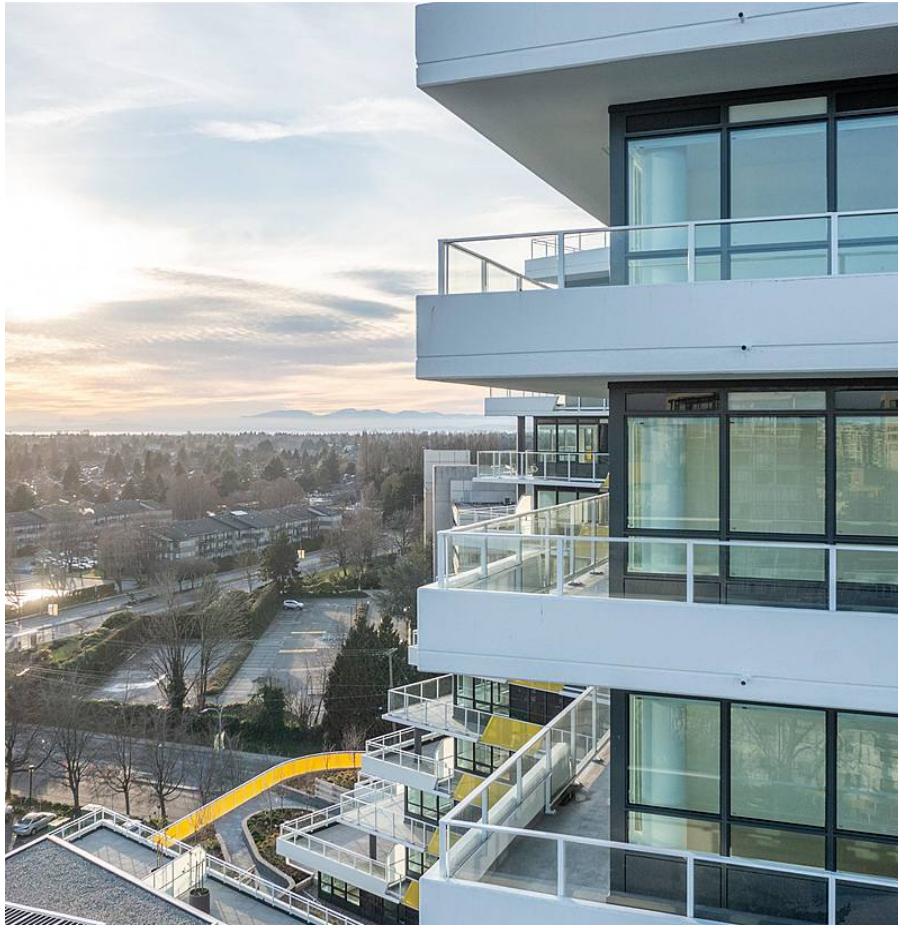

Well Laid out SE Corner home with generously sized & separated bedrooms in Richmond's most iconic building, CASCADE CITY by Landa Global . This home features approx . 1000 SF Outdoor Patio, plenty of windows for natural light; A/C, Miele appliance package+ engineered hardwood floors throughout! Surrounded by restaurants, shops and services. Richmond Centre, Aberdeen Centre+ YVR airport all a short drive away! Easy to get downtown w/ Canada Line nearby. Amenities incl. exclusive 3,000sf double-height Fitness Centre, Guest Suite, multi-functional Club Lounge, lushly landscaped 25,000sf podium-level outdoor space+ much more! Parking and Storage included!

KEY INFORMATION

MLS® R2746585

Residential Attached

Brighthouse

2 Bedrooms

2 Bathrooms

849 SF

\$475.44 Maintenance Fees

FEATURES

Year Built: 2022

Views: CITY

Listed By: rennie & associates realty ltd.

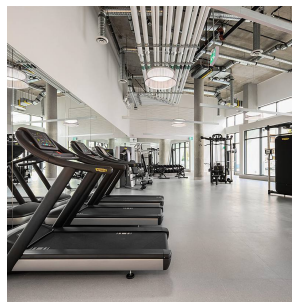
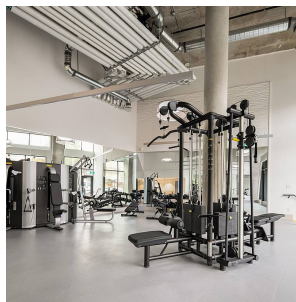
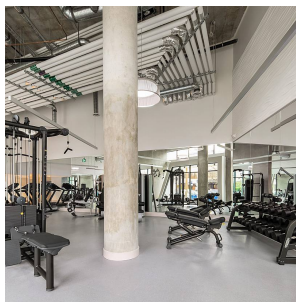

Hanson Lu PREC*
604.787.2578
hlu@rennie.com
rennie.com/hansonlu



Jessica Lozada PREC*
604.360.0025
jlozada@rennie.com
rennie.com/jessicalozada

rennie