

8055 Cypress Place, Whistler

\$2,899,000

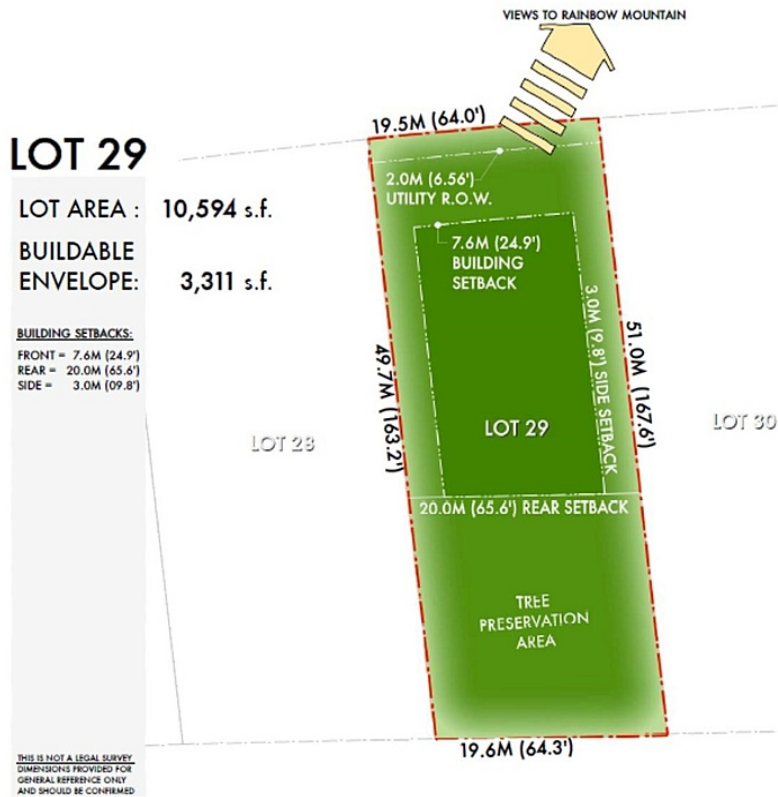

The natural features of Cypress Place are truly spectacular. In addition to its prime location, you couldn't ask for better building conditions, easy access, flat lot, sunny, southwestern exposures, amazing mountain views. This lot backs onto a treed area, oriented to take advantage of tpart golf course views between lots 14 and 15 across Cypress Place towards Sproat and Rainbow Mtns. Situated a few lots south of the tree tpreservation area, the lot affords privacy against a wooded back drop of conifers to the east. This pre-graded flat lot is 10,594 sq ft and is raised above the natural woodland floor with a maximum buildable area of 3,311 sq ft (excluding garage). Cypress Place allows nightly rentals, providing great potential for rental income in a future home.

KEY INFORMATION

MLS® R2841224

Land Only

Green Lake Estates

0 Bedrooms

0 Bathrooms

0 SF

10,594 SF Lot

FEATURES

Views: MOUNTAINS

Listed By: Sutton Group-West Coast Realty

rennie