

# 34704 Dewdney Trunk Road, Mission

\$1,025,000



Large 2 level home on massive 16,520 sq ft lot in premium Hatzic Bench location! This home is a handyman special, 3 bedroom, 2 bath main floor with kitchen, living room and dining room. Basement is partially finished with 2 bedrooms, storage room, rec room and 1 car garage. This is a one of a kind lot, all flat and usable, plenty of space to park your truck and RV, build a shop, you name it. City sewer is a stones throw away if you would like to pursue development ideas. Very rare to find a lot this large and this flat with 2 road frontages in Hatzic, call today!

## KEY INFORMATION

MLS® R2845007

Residential Detached

Hatzic

5 Bedrooms

3 Bathrooms

2,288 SF

16,520 SF Lot

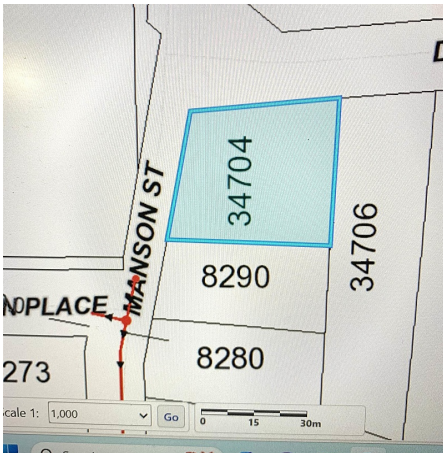

## FEATURES

Year Built: 1974

Listed By: Homelife Advantage Realty (Central Valley) Ltd.



rennie