

# 4511 Boundary Road, Richmond

\$3,500,000

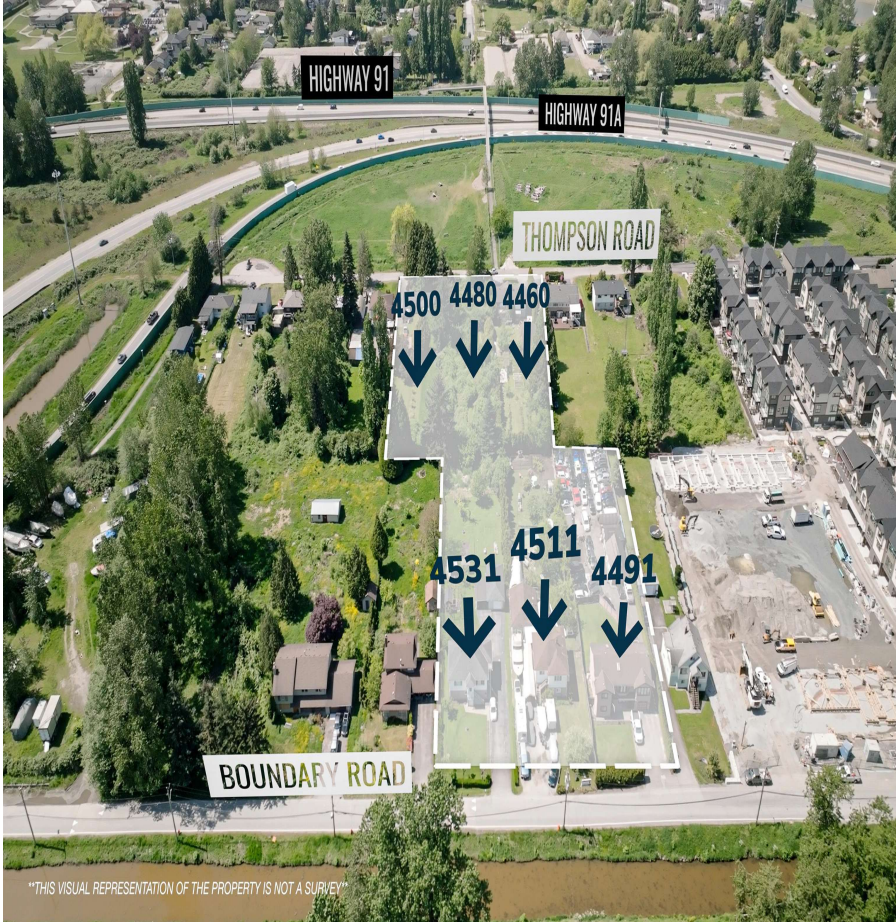

Developers Alert!!! This property is part of Land Assembly in the Heart of Lower Mainland (Hamilton Area of Richmond). These properties are located just West of Alex Fraser Bridge with easy access to Vancouver, Downtown, Richmond, Surrey/Delta, New West/Burnaby, Airport/Oak, QB, Knight St Bridge etc. Over 3 Acres and Potential for more land to be part of this last large remaining piece of land in Richmond. Prime properties to rezone for Multi Family use with the Province/Cities encouraging higher density to cope with Housing shortage. Exceptional opportunity for the Developer to build affordable housing for the First Time & Move Up Buyers and Empty Nester in a very Serene location close to Fraser River in the center of Lower Mainland. Please do not enter property without an appointment.

## KEY INFORMATION

MLS® R2858588

Residential Detached

Hamilton

4 Bedrooms

2 Bathrooms

1,732 SF

21,477 SF Lot

## FEATURES

Year Built: 1957

Views: CANAL

Listed By: RE/MAX Real Estate Services

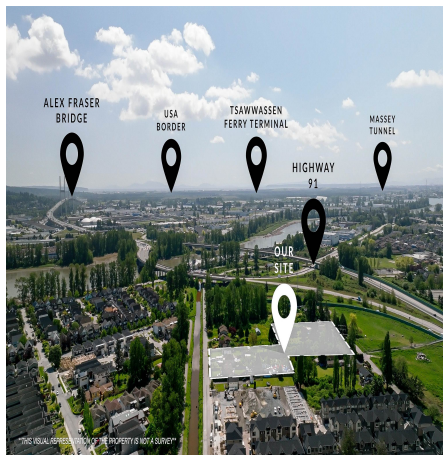

rennie