

# 1943 Panorama Drive, North Vancouver

\$1,449,000



Builder/Investor or Renovator? One of the original cottages in the heart of Deep Cove on a level 6,000 SF lot w/a private backyard backing onto a pedestrian lane & some view potential. Roof 7 yrs. RS4 zoning. Tenanted & being sold as-is, where-is. Requires a reno or tear down-build your dream home & live on Panorama Drive, an idyllic, dreamy little block of heaven in picturesque Deep Cove. Live just blocks from the beach, grab donuts at Honeys, dinner at Arms Reach & the soon to be revitalized Downtown Deep Cove. Rec possibilities are endless: Hiking, Paddling, Riding, Skiing. Living here, you will feel like you're on vacation. This property is on an amazing family street w/lots of kids, in a great school catchment close to Cove Cliff Elem and Seycove Sec. Priced well Below Assessment

## KEY INFORMATION

MLS® R2860826

Residential Detached

Deep Cove

2 Bedrooms

1 Bathroom

1,148 SF

5,000 SF Lot

## FEATURES

Year Built: 1932

Listed By: RE/MAX Treeland Realty

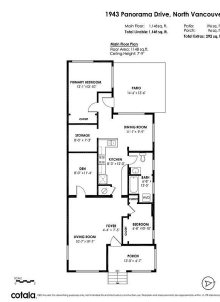

rennie