

517 11655 Fraser Street, Maple Ridge

\$489,000



ASSIGNMENT OF CONTRACT. This unit offers a functional floor plan with 604 sqft and is located on the **TOP PENTHOUSE** level with **SOUTH** exposure for ample natural light. It is within a short walking distance to the West Coast Express and boast well-designed access to transportation, making it very convenient to reach all areas of the city. Additionally, it is situated within walking distance of shopping, restaurants, parks and trails.

KEY INFORMATION

MLS® R2862279

Residential Attached

East Central Maple Ridge

1 Bedroom

1 Bathroom

604 SF

\$273.95 Maintenance Fees

FEATURES

Year Built: 2024

Listed By: Evergreen West Realty

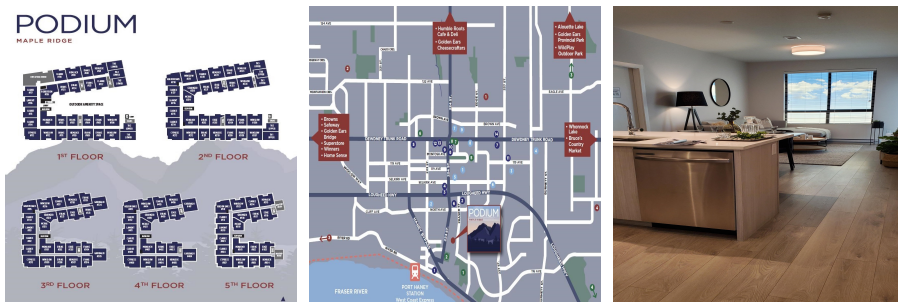
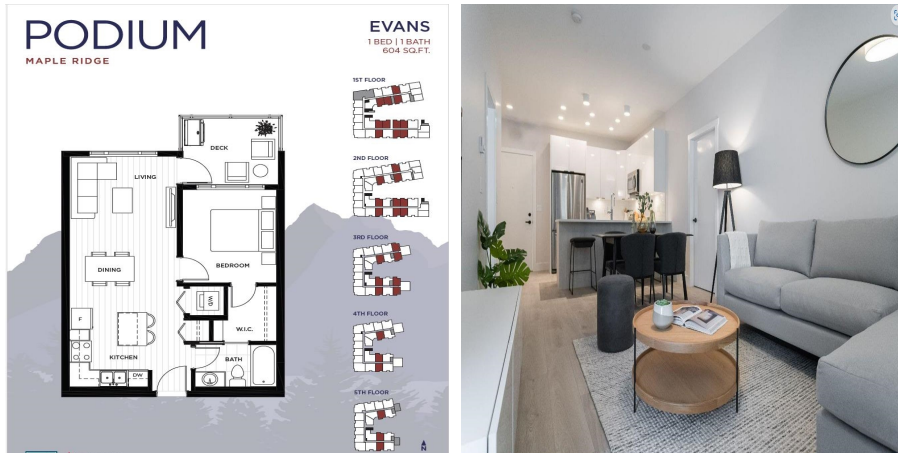

rennie