

# Th5 1102 Esquimalt Rd, Esquimalt

\$979,900



75% sold!! Located in the heart of Esquimalt Village, The Proxima is perfectly positioned for a life full of adventure, experiences, & amenities w/ Saxe Point Park, local breweries, Esquimalt Market, shopping, & the Archie Browning Sports Centre just a stone's throw away. A variety of 89 units consisting of 1, 2, 3 bedroom, penthouse, and townhouse units are now available brought to you by award winning GT Mann Contracting. Stunning interior finishing choices & superior space planning provided by Spaciz Design featuring quartz countertops, eat in kitchen island, deluxe black stainless Kitchen Aid appliance pkg, heated ensuite flooring, fireplace, & heat pumps w/ cooling. Whether relaxing on the sunny balcony, working out in the state-of-the-art gym, visiting the atrium or courtyard, residents can live life their way at The Proxima. (id:56120)

## KEY INFORMATION

MLS® 965388

Residential Attached

Rockheights

3 Bedrooms

3 Bathrooms

1,450 SF

1,226 SF Lot

## FEATURES

Year Built: 2024

Listed By: Coldwell Banker Oceanside Real Estate

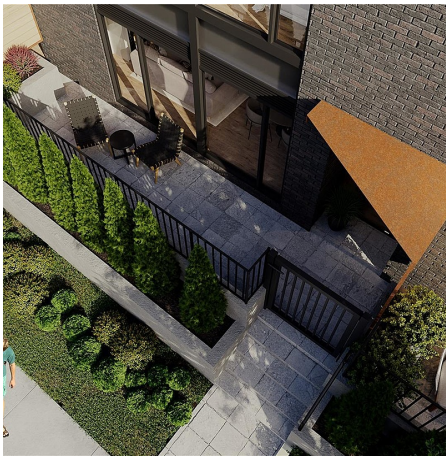

rennie