

12842 Alouette Road, Maple Ridge

\$2,750,000



3.91 acres with potential for three lot subdivision keeping the house in place. Application was made but the seller let it expire. Subdivision plan in photos Features three bedroom rancher with hardwood floors, newer, maple kitchen, including granite countertops and backsplash. There's an amazing outbuilding that could have potential for a conversion to garden suite that is currently used for a dog kennel (26x30). There is also a barn and a second shop and boat garage. This outstanding property has city water and sanitary on the street. House has new metal roof in June 2024 (\$70,000 +) Located near schools, transit and parks.

KEY INFORMATION

MLS® R2894644

Residential Detached

Websters Corners

4 Bedrooms

2 Bathrooms

1,508 SF

170,319 SF Lot

FEATURES

Year Built: 1961

Views: Forest

Listed By: RE/MAX LIFESTYLES REALTY

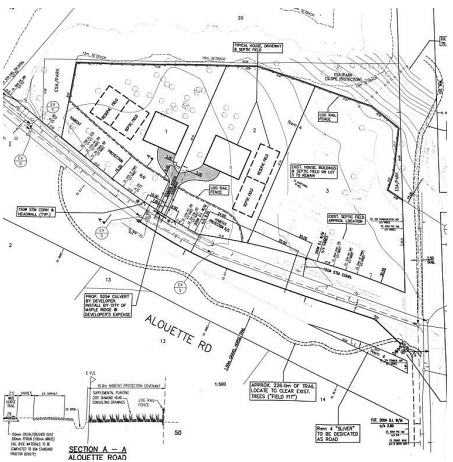

rennie