

# 507 11913 Burnett Street, Maple Ridge

\$639,900



Welcome to this exquisite 2-bedroom, 2-bathroom condo in Central Maple Ridge, close to all amenities. Move-in ready in 2024, this brand-new, northwest-facing corner unit is filled with natural light. The modern design includes central air conditioning and heating for year-round comfort. The kitchen features a high-end GE appliance package and a spacious island seating 4-5, perfect for entertaining. This top-floor unit offers an open-concept dining and family room with 9-foot ceilings. The master bedroom boasts a walk-in closet and a serene south-facing balcony. Enjoy two balconies, a rooftop deck with 360-degree views, a community garden, sitting area, fire pit, party room, and gym. Don't miss this exceptional home!

## KEY INFORMATION

MLS® R2899949

Residential Attached

East Central Maple Ridge

2 Bedrooms

2 Bathrooms

1,026 SF

\$344.61 Maintenance Fees

## FEATURES

Year Built: 2024

Listed By: Century 21 Supreme Realty Inc.

## FLOOR PLANS

A HOME FOR EVERYONE

Choose from one of three different 1 & 2 bedroom layouts, ranging from 850 sq ft to over 1,000 sq ft in size. No matter which selection you make, at The Ridge, you'll come home to a thoughtfully designed space with an open concept floorplan and spacious decks that extend living from inside to out.

→ #507



PLAN A

PLAN B

PLAN C

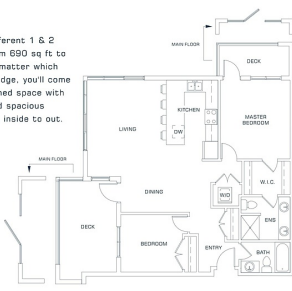

**PLAN A**  
2 BEDROOM  
1,026 SQ. FT.

|                                |                          |
|--------------------------------|--------------------------|
| Living - 12'7" X 16'10"        | Bedroom - 10'11" X 10'2" |
| Dining - 11'8" X 7'11"         | Deck 1 - 10'7" X 10'8"   |
| Kitchen - 8'8" X 13'7"         | Deck 2 - 9'0" X 7'0"     |
| Master Bedroom - 11'7" X 12'0" |                          |

