

18942 62 Avenue, Surrey

\$1,349,000

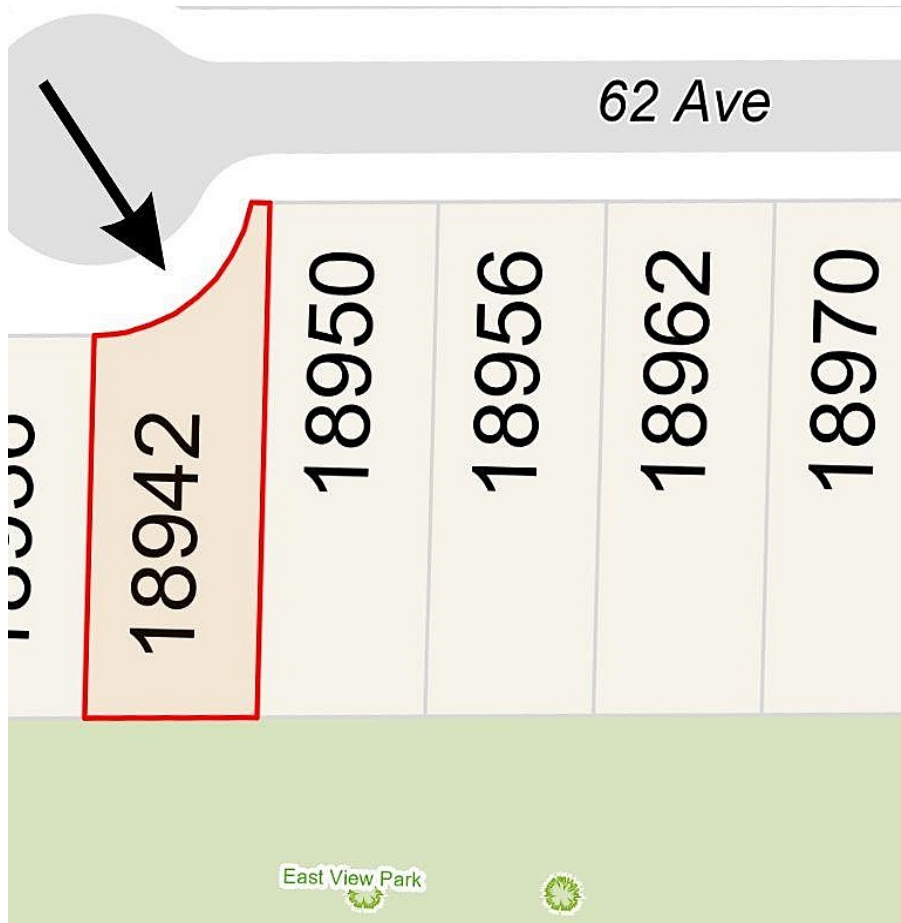

Welcome to this exceptional cul-de-sac lot, where your dream home awaits. Nestled in a tranquil neighbourhood, this 6,136 sq/ft parcel offers a canvas for your vision. Situated at a quiet cul-de-sac, this lot provides privacy and seclusion. With ample space, you can design a three-story home that suits your lifestyle (must verify with City and your designer). Despite its peaceful setting, this lot is conveniently located near shopping centers, restaurants, and major transportation routes. Don't miss out on this rare opportunity.

KEY INFORMATION

MLS® R2913343

Land Only

Cloverdale

0 Bedrooms

0 Bathrooms

0 SF

6,136 SF Lot

FEATURES

Listed By: Sutton Group-Alliance R.E.S.

rennie