

# 4 29609 Hudson Avenue, Mission

\$899,900

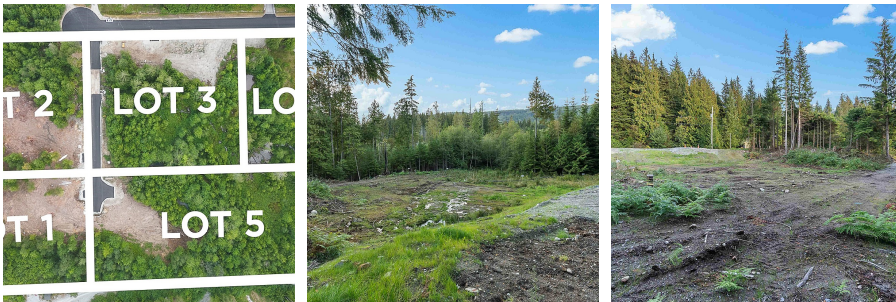

**APE**  
ecture Inc.  
earchitecture.ca



Design that dream home, build that shop! Lot 4 of five newly developed building lots. This 1.73 acre lot features two road frontages, backs onto greenbelt and the topography favors level entry homes with walk out basements. RR7S-zoning allows for secondary dwelling units inc. suites and carriage homes, perfect for multigenerational living. This exclusive subdivision is designed around a meandering creek, offering privacy and enhancing the property's natural beauty. Building envelopes are optimized to provide for spacious homes. Each lot is serviced with gas, hydro (400 Amp), pre drilled wells and are ready for you to begin building. Bordering Mission and Maple Ridge, this stunning location offers a serene lifestyle with easy access to trails, mountains, lakes and only 15 minutes to town.

## KEY INFORMATION

MLS® R2937802

Land Only

Stave Falls

0 Bedrooms

0 Bathrooms

0 SF

75,358 SF Lot

## FEATURES

Views: Mountains/Green Belt

Listed By: Homelife Advantage Realty (Central Valley) Ltd.

**rennie**