

24833 Robertson Crescent, Langley

\$1,849,900



This stunning 8200 SqFt property in rural Langley is sure to impress. You'll love the spaciousness, with over 3600 SqFt on 2 levels + oversized garage. The wide foyer w/ adjacent office welcomes you upon entry. Main floor features a great room w/ high ceilings & an opulent fireplace, a roomy kitchen with an oversized island, high-end appliances, & optional spice kitchen w/ walk-in pantry. Primary bedroom w/ rear yard access, a luxurious spa ensuite w/ two sinks, a soaker tub, a level-entry shower, and a massive walk-in closet. Upstairs: four generously sized bedrooms, all with ensuites. Quality construction and fine finishing materials throughout. Large backyard provides space for entertaining & relaxing. This home is perfect for those who enjoy the peace and tranquility of rural living.

KEY INFORMATION

MLS® R2940358

Residential Detached

Salmon River

6 Bedrooms

5 Bathrooms

3,650 SF

8,227 SF Lot

FEATURES

Year Built: 2025

Listed By: RE/MAX Treeland Realty

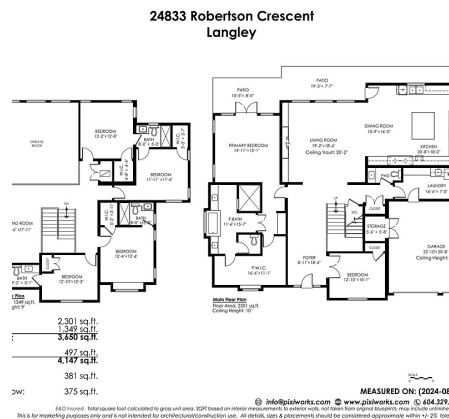

rennie