

1180 Maple Rd, North Saanich

\$2,749,000

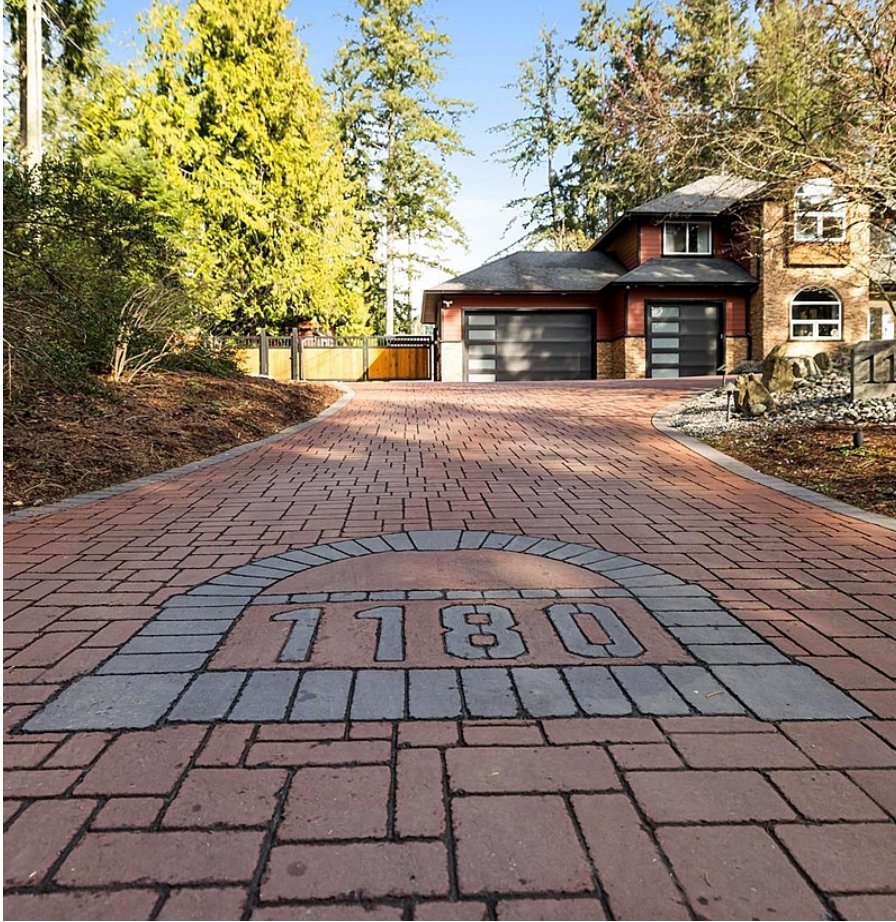

This North Saanich acreage checks all the boxes! Custom-built 5,000+ sq. ft. primary residence with an attached three-vehicle garage, a newly built legal detached 2-bed, 2-bath garden suite complete with natural gas appliances and air conditioning (generating \$55,000 in Airbnb revenue in 2024), and an oversized detached garage or workshop. The primary residence offers 5/6 bedrooms and 5 bathrooms, providing ample space for family (with 4 bedrooms upstairs) and guests alike. Entertainment reaches new heights with a movie theatre and a stylish bar, ensuring every gathering is unforgettable. A motorized vehicle gate grants access to the fenced rear property, where you'll find the detached garage/workshop and the \$4,500/mo revenue-earning garden suite. Peace of mind is assured knowing that the primary home, garden suite, and detached workshop are legally permitted and include a brand-new septic system. (id:56120)

KEY INFORMATION

MLS® 980925

Residential Detached

Lands End

7 Bedrooms

7 Bathrooms

6,704 SF

43,560 SF Lot

FEATURES

Year Built: 2006

Listed By: eXp Realty

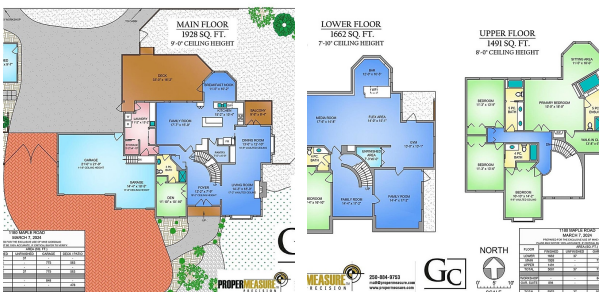

rennie