

Th 1 135 E 13 Street, North Vancouver

\$1,799,900



Luxury living, enhanced by inspiring panoramas of Burrard Inlet and the Vancouver skyline – impressive by day, magical at night. The 18-storey residential tower, anchored by a commercial podium topped with resort-style amenities, carves an elegant profile against impressive water and mountain views. Innovative floor plans with window walls showcasing stunning views. Large terraces for seamless indoor-outdoor living and entertaining. Every detail a blend of elegance and functionality. The kitchen is a feast for the eyes with luxurious marble style quartz countertops, Miele appliances, and European style cabinetry. Interiors are customized to individual tastes with crafted Pearl colour scheme.

KEY INFORMATION

MLS® R2952513

Residential Attached

Central Lonsdale

3 Bedrooms

3 Bathrooms

1,700 SF

\$954.60 Maintenance Fees

FEATURES

Year Built: 2025

Listed By: Magnum Projects Ltd.

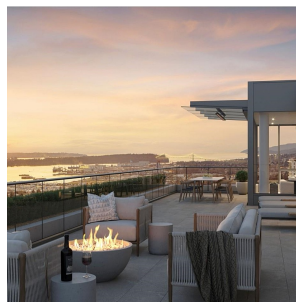
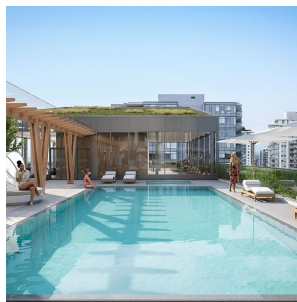
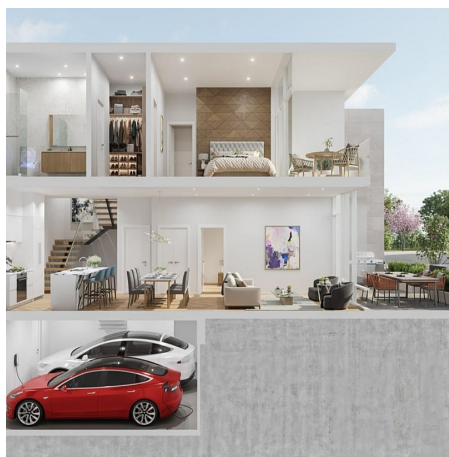

rennie