

1903 Warwick Crescent, Port Coquitlam

\$1,419,900

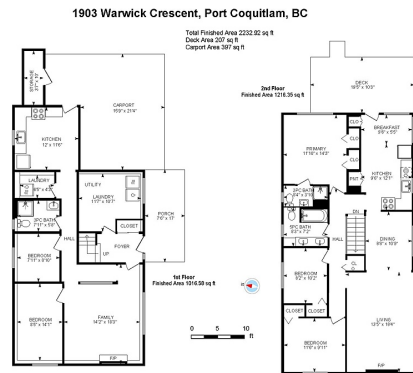

Beautifully updated & well appointed home on a corner lot with views of the city & mountains! The updates on this home are extensive with new kitchen up & down, new laminate and tile flooring throughout, updated bathrooms, furnace in 2021, new deck with new flooring, vinyl and railing, new modern lights, electric fireplace in the upstairs living room & new windows throughout. The upstairs is open & spacious offering 3 bedrooms and 2 full baths. The basement is built above ground with large windows & offers an open living room, modern kitchen with lots of cabinets, 2 bedrooms, its own laundry room with storage and separate entry. You are located close to transit with easy access to shopping & schools. OPEN HOUSE: Saturday & Sunday Jan 18 & 19, 2:00-4:00PM.

KEY INFORMATION

MLS® R2952611

Residential Detached

Mary Hill

5 Bedrooms

3 Bathrooms

2,232 SF

4,697 SF Lot

FEATURES

Year Built: 1976

Views: City and Mountain Views

Listed By: RE/MAX Sabre Realty Group