

# 14116 88 Avenue, Surrey

\$1,348,888



Welcome to Beautiful Rancher on huge 8323 sqft lot, with a potential for future MULTI-FAMILY development including a 4-Plex (check w/city), this home offers 5 bedrooms & 2.5 baths with a good sized family room opens to a covered deck in the back yard plus a large driveway can fit 4 cars plus a spacious double garage. A walking distance to beautiful Bear Creek Park, Surrey Art Gallery, Temple, and buses on 88 Ave. Enver Creek Secondary and Brookside Elementary are 5 minutes drive away. Located in a highly developing area with potential for future development under the proposed Fleetwood Plan. The close proximity to the new Skytrain station will add value in the future. Perfect for investors or families looking for this large lot in highly sought-after neighborhood of GREEN TIMBERS area.

## KEY INFORMATION

MLS® R2952504

Residential Detached

Bear Creek Green Timbers

5 Bedrooms

3 Bathrooms

1,581 SF

8,323 SF Lot

## FEATURES

Year Built: 1990

Listed By: Team 3000 Realty Ltd.

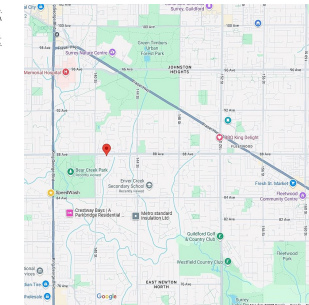
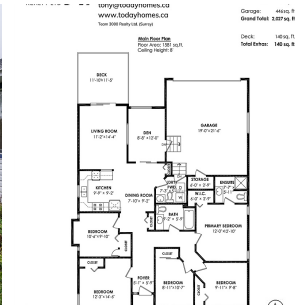

rennie