

101 101 Parkside Drive, Port Moody

\$1,495,000



Welcome to this beautifully maintained townhome, TREETOPS MOST DESIRED STREET-Bramble Lane, located in the heart of Port Moody! Nestled in a peaceful and family-friendly community. Boasting 4 spacious bedrooms and 4 bathrooms, this property features an open-concept layout, a bright and airy living space, and a modern kitchen with stainless steel appliances. Just steps to the amenities of indoor pool/hot tub/sauna and gym is this gem showcasing pride of ownership. New windows (Dec 2022), 6-year-old roof, Walk to Heritage Mtn Elem/Eagle Mtn middle/Heritage Mtn highschool. 1 blk to bus and 2-minute drive to inlet skytrain, Suterbrook/Newport, Brewers Row, Rocky Point, Hospital and more. ** Quick possession is possible. **

KEY INFORMATION

MLS® R2956509

Residential Attached

Heritage Mountain

4 Bedrooms

4 Bathrooms

2,832 SF

FEATURES

Year Built: 1993

Listed By: Royal Pacific Tri-Cities Realty

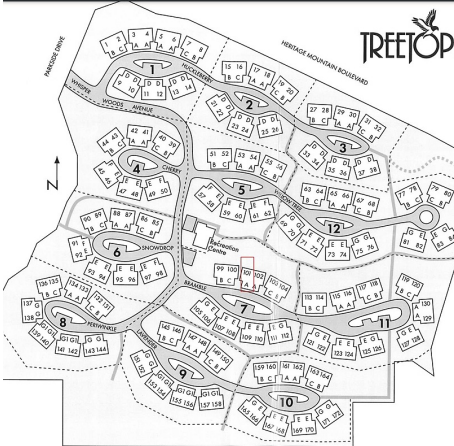

rennie