

1503 10750 135a Street, Surrey

\$499,990

1 BEDROOM + DEN
1 BATH
485 SQ FT MAIN
101 SQ FT BALCONY

1503

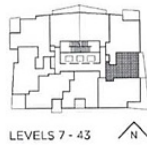

The developer reserves the right to make modifications and changes to features and finishes, brands, materials, building and landscape design specifications, ceiling heights, flooring patterns and floorplans without notification. Approximate suite sizes are computed from the outside face of exterior walls, the perimeter of exterior air common walls, and the centerline of walls adjacent to other strata lots. Approximate measurements for exterior balconies and

LUXURY 1 Bed, Den, 1 Bath, 15th floor, 485 SF with 100 SF Balcony. The Grand on King George Surrey's first luxury high-rise featuring 5 floors of commercial provides residents potential for coffee shops, medical offices & daycare right at their doorstep. The 6th floor has over 23,000 sf of amenities including 24/7 concierge, an off-leash skypark for pets, a private VR room, state of the art fitness room & an expansive outdoor BBQ, park & playground area. The most features & finishes of any high-rise, suites include custom millwork doors, closet organizers with built-in lights, CENTRAL HEATING & COOLING, wifi enable Samsung appliances, GAS cooktops (included in strata) kitchen cabinet organizers and so much more.

KEY INFORMATION

MLS® R2957673
Residential Attached
Whalley

1 Bedroom
1 Bathroom
485 SF
\$282.87 Maintenance Fees

FEATURES

Year Built: 2025
Views: CITY AND MOUNTAIN
Listed By: Jovi Realty Inc.

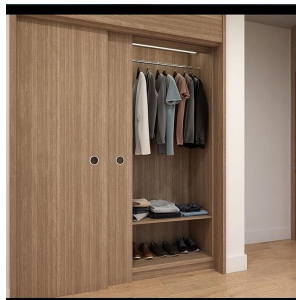
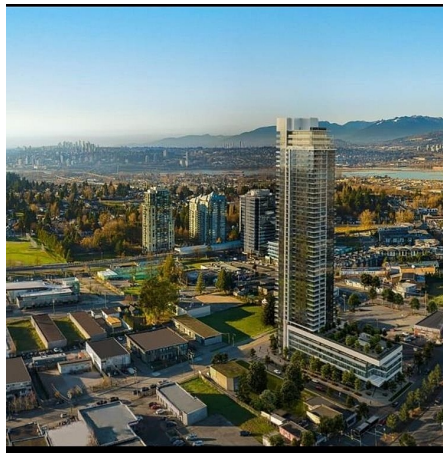

rennie